

SECTION AT - 'A-B'



SITE PLAN
SCALE : 1:400

SLOPING ROOF

TERRACE FLOOR PLAN - SHED

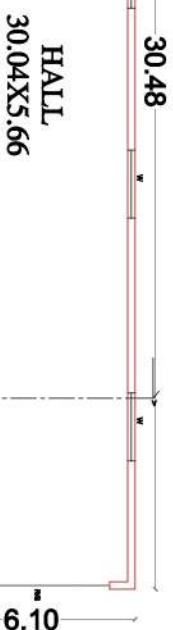

GROUND FLOOR PLAN - SHED

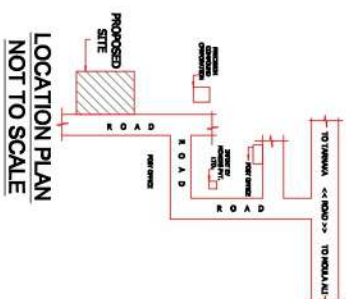

PLAN SHOWING THE PROPOSED PRODUCTION SHED ON
PLOT NOS.B-14 & B-23, SITUATED AT APIC ESTATE, MOULALI
INDUSTRIAL AREA R.R. DIST. T.S.

BELONGS TO : M/S. BEML LTD.

(FORMERLY M.S. BHARATH EARTH MOVERS LTD.)

REFERENCE :-

PROPOSED : -
EXISTING : -
TO BE DISMANTLED : -

SCALE : 1 : 100 (ALL DIMENSIONS ARE IN METERS)

AREA:

TOTAL PLOT AREA : 7062.00 SQ.MTS

EXISTING BUILT UP AREA : 855.74 sq.mts

SURFACE PARKING AREA : 385.54 sq.mts PARKING

PROP. G.FLR PLINTH AREA : 185.81 Sq.mts (SHED)

TOTAL PLINTH AREA : 185.81 Sq. mts.

10% OF BUILT UP AREA TO MORTGAGE : 18.58 Sq. mts.

5% TOTLOT AREA : 353.00 sq.mts

SPECIFICATIONS :-

FOUNDATIONS : CRS MASONRY IN C.M.
FOUNDATION BED : P.C.C. 1:4:8
COLUMNS, BEAMS & ROOFING : G.I. SHEET.
SUPER STRUCTURE : BRICK IN C.M.
JOINERY : ALUMINIUM PARTITIONS.
FLOORING : INDUSTRIAL FLOORING
PLASTERING : IN C.M.

JOINERY:

DOORS : D: 1.2 X 2.1, D1: .09 X 2.1, D2: 0.76 X 2.1.
WINDOWS: W: 2.0 X 1.2, W1: 1.2 X 1.2, W2: 1.2 X 0.91,
V: 0.76 X 0.45.
R/S: ROLLING SHUTTER 4.5X3.15,

OWNERS SIGNATURE

ARCHITECTS & ENGINEERS

hanuman planners
STRUCTURAL ENGINEERS & ARCHITECTS.
16-11-310/15/1/3/5, SAKSHI TOWER,
OPP. TV TOWER, MUMBAI, INDIA-400004
PHONE: 92471988 (CELL)

