

| NO. | PART NO. | TUBE O.D (mm) | T G (PF) | WIDTH ACROSS FLAT | | K | L | L1 | L2 |
|-----|-----------|------------------|-------------|-------------------|----|----|------|----|----|
| | | | | H | h | | | | |
| 1 | 909-60240 | 22 | 1/2" | 27 | 27 | 27 | 60.0 | 14 | 44 |

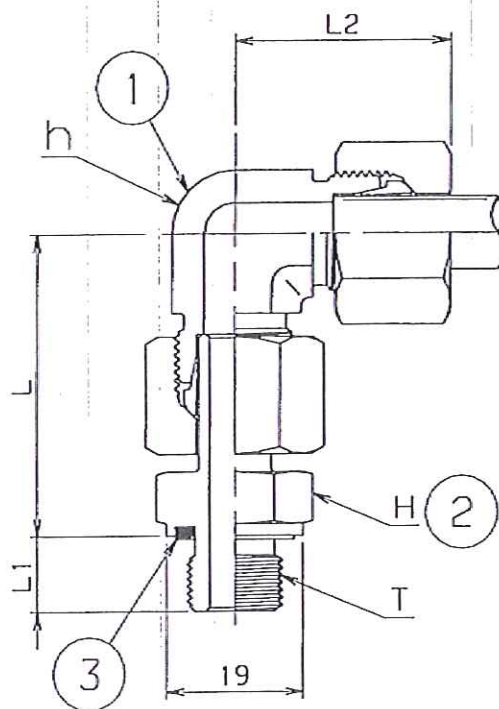

NOTE

THE STRENGTH AND NO AIR LEAKAGE SHALL BE
GUARANTEED UNDER THE CONDITION OF NO. 1 AND 2.

1. TEMPERATURE RANGE : $-40 - +80^{\circ}\text{C}$
2. OPERATING PRESSURE : MAX. 80 BAR
3. END FITTING SHALL BE OF FLARELESS DOUBLE COMPRESSION TYPE
& CONFIRM TO SPECIFICATION: DIN2353 (ISO8434-1)
- SHALL BE APPLIED FOR DIMENSIONS NOT SPECIFIED AT DRAWING

| 3 | 1 | | O-RING | | NBR | |
|--------|---------------------------------|------------------|--------------------------------------|-----------------------|-----------------------|---------------------|
| 2 | 1 | | ADAPTOR | | SUS316 | |
| 1 | 1 | 909-60190 | UNION ELBOW | | SUS316 | |
| SL No. | QTY | DRG. / STOCK No. | DESCRIPTION | SIZE | COMPANY STD / IS STD | Wt.Kg. |
| | | | DETAIL PARTS | | MATERIAL | |
| | | | PRODUCT DMRC 8 CAR | | | |
| | | | | | SURFACE TREATMENT | |
| | | | | | APPROVED | <i>[Signature]</i> |
| | | | | | CHECKED | <i>[Signature]</i> |
| | | | | | DRAWN | <i>[Signature]</i> |
| 1 | ECN No.90900487 NOTE 3 ADDED | 07.08.2015 | SK <i>[Signature]</i> | SM <i>[Signature]</i> | MS <i>[Signature]</i> | REF DRG EE01646-402 |
| ALT | CHANGES / ECN No. | DATE | BY | CKD | APP | QTY |
| | | | | | | NEXT ASSY |
| | | | | | | MODEL |
| | | | TITLE | | DRG No. | |
| | | | ADJUSTABLE ELBOW WITH ADAPTER (MALE) | | 909-60241 | |
| | | | | | SHEET 1 of 1 | |
| | | | | | ALT | |
| | | | | | 1 | |