

3		2				1			
MACHINING DEVIATIONS FOR LINEAR DIMENSIONS	RANGE	0 - 6	6 - 30	30 - 120	120 - 315	315-1000	1000-2000	2000-4000	ABOVE 4000
	TOLERANCE	±0.1	±0.2	±0.3	±0.5	±0.8	±1.2	±2	±3
FOR DIMENSIONAL TOLERANCES OF SHEET METAL PARTS AND WELDED STRUCTURES, REFER STD. RD-227									
UNSPECIFIED TOLERANCE FOR LINEAR AND ANGULAR DIMENSIONS REF. IS 2102 (PT-1) (MEDIUM)									
VALUES OF SURFACE TEXTURE SHALL BE AS PER COMPANY STD DS. 1012.C.						PROTO / PILOT / PRODUCTION			
QUALITY OF WELD JOINTS REF. RD-230 MEDIUM									

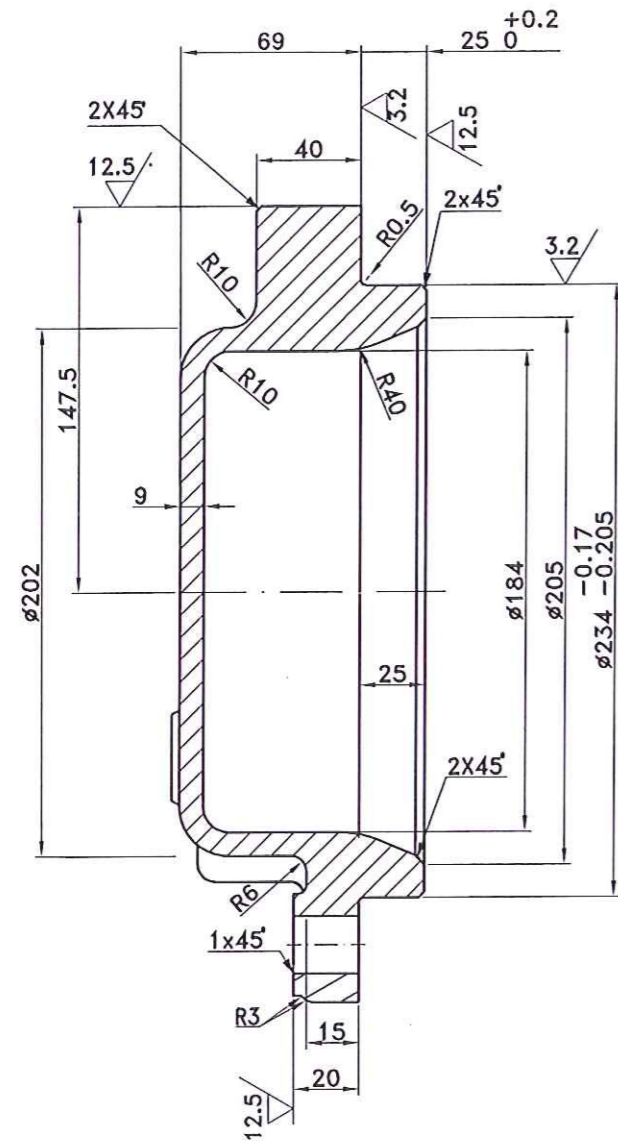

SECTION A-A

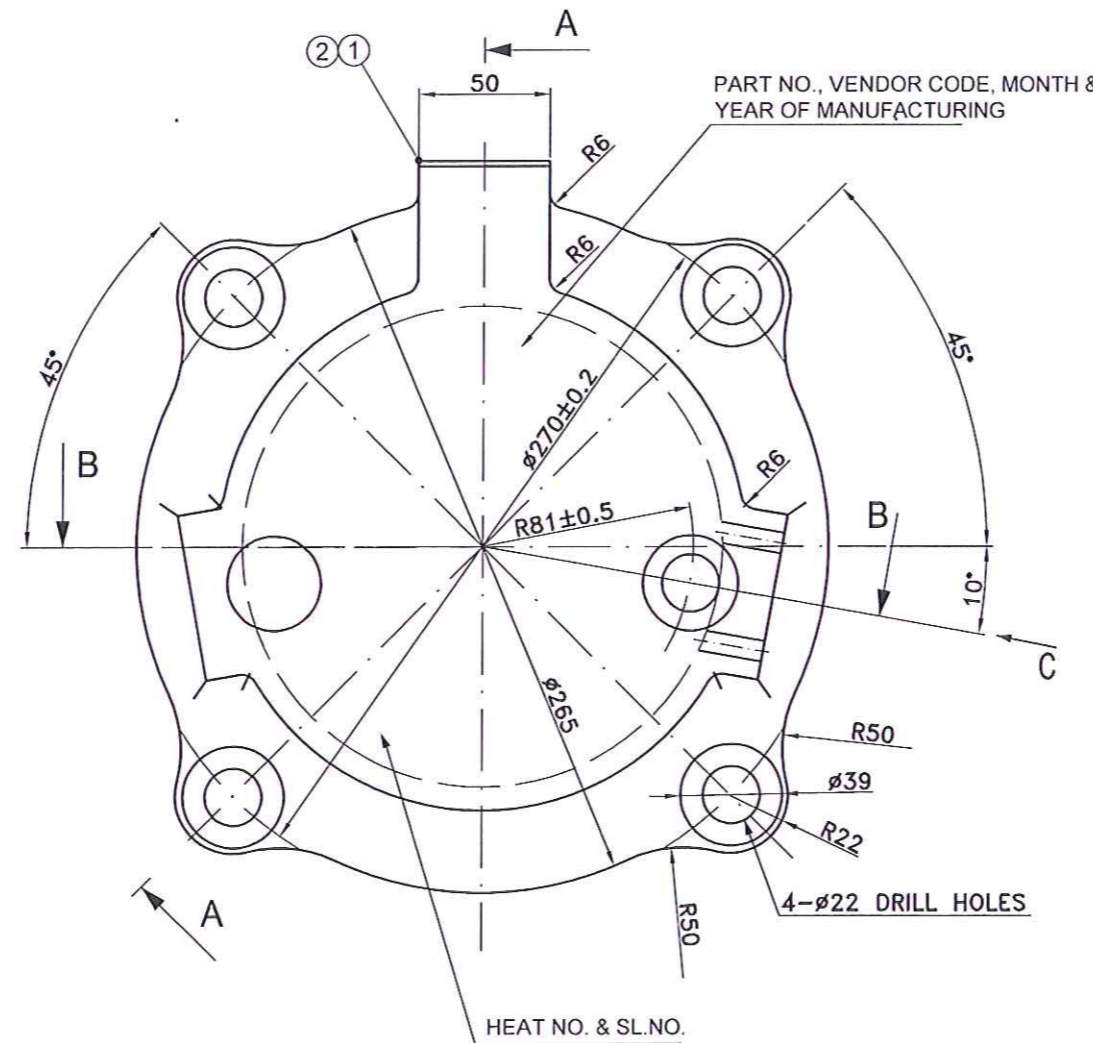

- 1 NOTES:-

1. CONSIDER R3 FOR UNSPECIFIED RADIUS ON CASTING.
2. SCREW MACHINING SHALL BE DONE ACCORDING TO ISO 261 NORMAL GRADE OR ABOVE.
3. DEVIATIONS ON UNTOLERANCED CAST DIMENSIONS SHALL BE TO IS:4897-1994, CLASS-2.
4. EMBOSS IN 10mm HIGH, 1.5mm RAISED LETTERS PART NO., VENDOR CODE, MONTH & YEAR OF MFG., HEAT NO. & SL.NO. ON THE CASTING AS SHOWN IN THE DWG.
5. FAI: ONE NO. OF FINISH MACHINED SAMPLE COVER FRONT (WSP) SHALL BE SUPPLIED FREE ALONG WITH ALL MECHANICAL & CHEMICAL TEST REPORTS AND DIMENSIONS CHECKSHEETS FOR APPROVAL BY BEML BEFORE BULK PRODUCTION.
6. THE CASTINGS SHALL STRICTLY CONFORM TO BEML PTS DOC.NO. GR/TD/1477 (REFER LATEST REVISION).

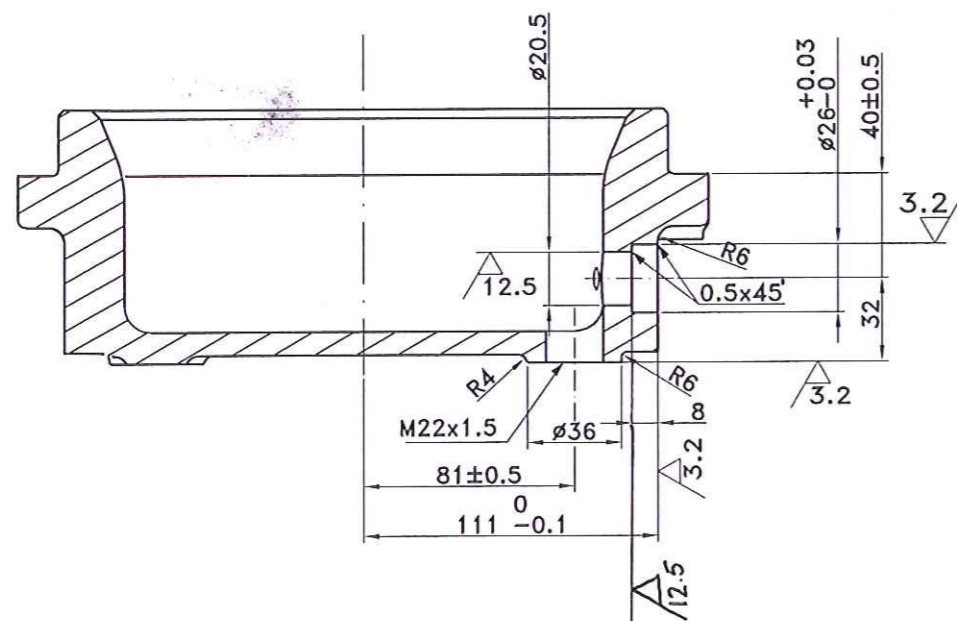

SECTION B-B

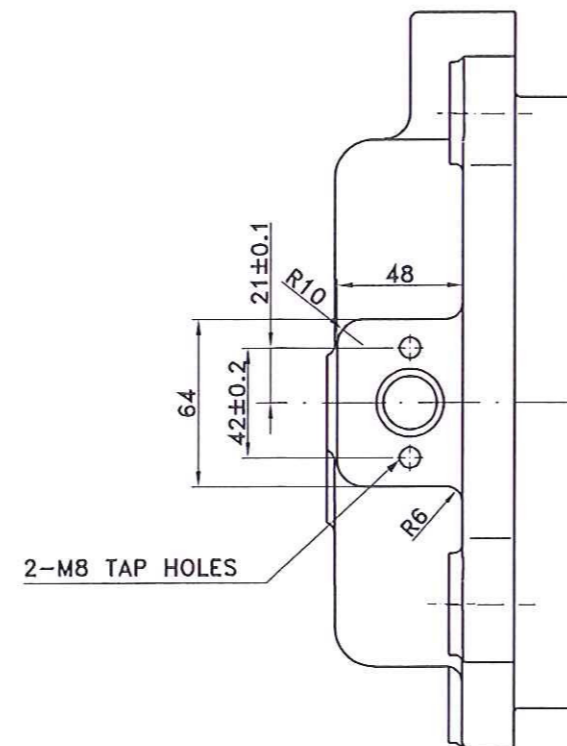

VIEW C

UN CONTROLLED COPY

2	1		COVER FRONT (RH) OPPOSITE		IS:1030-98 GR. 230-450W NORMALISED	
1	1		COVER FRONT (LH) AS SHOWN		IS:1030-98 GR. 230-450W NORMALISED	
SL No	QTY	DRG. / STOCK No.	DESCRIPTION		SIZE	COMPANY,STD./IS,STD
		DETAIL PARTS		MATERIAL		
x1 3	REVISED AND REDRAWN ECN No. 90900651	6.01.17	ILYAS	DB	MS	PRODUCT
						METRO BOGIE
						SURFACE TREATMENT
x1 2	NOTES UPDATED ECN No. 90900650	24.12.16	ILYAS	DB	MS	APPROVED JP 5.1.08
						CHECKED GSK 5.1.08
x1 1	NOTE REVISED	26.04.11	PRATEEK	KSRR	JP	DRAWN ILYAS 4.1.08
						REF DRG 1104
						SCALE
						SHEET OF
						Wt (Kg) 11.5
ALT	CHANGES / ECN No.	DATE	BY	CKD	APP	QTY
						NEXT ASSY
						MODEL
						TITLE
						COVER FRONT (WSP)
						DRG No.
						909-81109
						ALT
						3

GRADE No.	N12	N11	N10	N9	N8	N7	N6	N5	N4	N3	N2	N1
VALUE	50/	25/	12.5/	6.3/	3.2/	1.6/	0.8/	0.4/	0.2/	0.1/	0.05/	0.025/
SYMBOL												